

**2018 Northeast Pasture Consortium Annual Meeting Agenda
January 25-26, Century House Hotel & Conference Center, Latham, NY**

<u>Date</u>	<u>Time</u>	<u>Activity</u>
25-JAN	8:00 AM	Welcome & Introduction of Participants - <i>Jim Cropper, Executive Director presiding, Main Ballroom</i>
	8:30 AM	<p>Session 1 – Riparian Area Management in Pastures, - <i>Moderator, Susan Parry, USDA-NRCS State Grassland Specialist, Harrisburg, PA. Main Ballroom</i></p> <p>Speakers: Erik Hagan, Riparian Conservation Planning Project Coordinator for ARS, Graduate student in Ecology, Pennsylvania State University, University Park, PA. <i>Evaluating Conservation Reserve Enhancement Program (CREP) Riparian Buffers in the Chesapeake Bay Watershed</i> Michael Nassry, Research Associate, Pennsylvania State University Riparia, University Park, PA. <i>The Riparian Ecosystem Services Assessment</i> Carlington Wallace, Post-Doctoral Scholar, Pennsylvania State University Riparia, University Park, PA & Visiting Scientist, USDA-ARS Hydrology and Remote Sensing Laboratory, Beltsville, MD. <i>Findings from Runoff Assessment Work</i> Tamie Veith, Agricultural Engineer, USDA–ARS Pasture Systems & Watershed Management Research Unit, University Park, PA. <i>Model Results Quantifying the Different Performance of Riparian Buffers</i> Morgan Hartman, Owner and Operator, Black Queen Angus Farm, LLC, Berlin, NY. <i>Farmer Perspective on Managing Riparian Area Pastures.</i></p>
	10:00 AM	Break – Main Ballroom
	10:30 AM	<p>Session 2 – Private Sector Breakout Session – <i>Moderator, Angus Johnson, Recorder, Cliff Hawbaker. Hudson-Halfmoon Room</i> Renew Stakeholder Action Committee - select members and Chairperson If time permits, begin reviewing previous research, education, and technical assistance priorities. Ascertain progress, and new direction if needed.</p> <p>Session 2 - Public Sector Breakout Session - <i>Moderator, Jenn Colby, Recorder, Jessica Williamson. Main Ballroom</i></p> <p>Topic: <i>Riparian Area Grazing Management – How do we implement a flexible planning approach to enhance riparian areas and water quality without breaking the bank or the farmer’s trust?</i></p>
	12:00 PM	Lunch - White Ballroom

2018 Northeast Pasture Consortium Annual Meeting Agenda
January 25-26, Century House Hotel & Conference Center, Latham, NY

<u>Date</u>	<u>Time</u>	<u>Activity</u>
25 JAN	1:00 PM	Session 3 – Pastures and Soil Health - Moderator, Fay Benson, Main Ballroom Speakers: Justin Morris , Regional Soil Health Specialist MN-WI, USDA-NRCS Soil Health Division, Madison, WI. <i>Improving Soil Health through Adaptive Grazing Management.</i> Dave Llewellyn , Director of Farm Stewardship at Glynwood, Cold Spring, NY. <i>Soil Health and Climate Resilience for Pasture-Based Livestock Farmers</i>
	2:45 PM	Session 4 – Silvopasture Update – Moderator, Jessica Williamson, Main Ballroom Speaker: Brett Chedzoy , SCNY Ag Team-Forestry Specialist; Sr. Resource Educator, Montour Falls, NY. <i>Where Silvo-Pasture Research and Extension are now.</i>
	3:15 PM	Poster Session – (authors present) Hudson-Halfmoon Room
	4:00 PM	Session 5 – Beef Viability Case Studies – Moderator, Jenn Colby, Main Ballroom Speaker: Sam Smith , Farm Business Specialist, Intervale Center, Burlington, VT. <i>Beef Viability Case Studies.</i>
	4:30 PM	Session 6 - Soil Health and its Impact on Human Health - <i>Moderator, Jenn Colby, Main Ballroom</i> Speaker: Didi Pershouse , Director, The Center for Sustainable Medicine & Board Member, Soil Carbon Coalition, Thetford Center, VT. <i>The Ecology of Care.</i>
	5:15 PM	Adjourn
	5:30 PM	Dinner – White Ballroom
	7:00 PM- 9:00 PM	Evening Session - Producer Showcase - Moderator, Don Wild, Main Ballroom Speakers: Bruce Rivington , Kriemhild Dairy Farms, Hamilton, NY. <i>Churning up butter profits - A grass fed dairy's adventure into processing</i> Eric Sheffer , Sheffer's Grassland Dairy, Hoosick Falls, NY. <i>Transitioning to Organic Dairying in Troubling Times.</i>

**2018 Northeast Pasture Consortium Annual Meeting Agenda
January 25-26, Century House Hotel & Conference Center, Latham, NY**

<u>Date</u>	<u>Time</u>	<u>Activity</u>
26-JAN	8:00 AM	<p>Session 7 – The Saturated versus Unsaturated Dietary Fat Controversy as it relates to Pasture-raised Dairy and Meat Products - <i>Moderator, Kathy Soder, Main Ballroom</i></p> <p>Speakers: Glen Lawrence, Professor of Chemistry and Biochemistry, Long Island University, Brooklyn, NY. <i>Good Fat versus Bad Fat: How Did They Get It So Wrong?</i> Adam Lock, Associate Professor, Dairy Cattle Nutrition, College of Agriculture & Natural Resources, Department of Animal Science, Michigan State University, Lansing, MI. <i>Separating Milk Fats from Fiction: can we alter milk fat composition on-farm and do we want/need to alter it?</i></p>
	9:30 AM	Break – Main Ballroom.
	10:00 AM	<p>Public and Private Sectors Breakout sessions</p> <p>Public Sector – <i>Chair, Jessica Williamson, Main Ballroom</i> <i>Recorder, Fay Benson</i></p> <p>Private Sector – <i>Chair, Cliff Hawbaker, Hudson-Halfmoon Room</i> <i>Recorder, Diane Schivera</i></p>
	12:00 PM	Lunch – White Ballroom
	1:00 PM	<p>Sector and USDA Agency Reports - <i>Jim Cropper, Executive Director presiding, Main Ballroom</i></p> <p>Private Sector report – <i>Cliff Hawbaker, Co-Chair Elect</i> Public Sector report – <i>Jessica Williamson, Co-Chair Elect</i> ARS report – <i>David Knaebel, Beltsville, MD, National Program Leader for Soil Biology and Soil Health</i> NIFA report - <i>Jim Dobrowolski, Washington, DC PowerPoint</i> NRCS Report – <i>Kevin Ogles, Greensboro, NC</i> Special Report – <i>Allen Matthews, Director and Instructor of Sustainable Agriculture, Chatham University, Pittsburgh, PA.</i> Grass Fed Beef Value Chain Marketing (Given by Jennifer Colby)</p>
	4:00 PM	Break – Main Room

**2018 Northeast Pasture Consortium Annual Meeting Agenda
January 25-26, Century House Hotel & Conference Center, Latham, NY**

<u>Date</u>	<u>Time</u>	<u>Activity</u>
26 Jan	4:15 PM	Business Meeting – Jenn Colby, Public Sector Co-Chair and Angus Johnson, Private Sector Past Co-Chair, Presiding, Main Ballroom

Margaret Smith, Administrative Advisor to NERA1603 (Northeast Pasture Consortium), NERA1603 Project for 2016-2021

Election of Private Sector and Public Sector members-at-large to serve on the Executive Committee of the NE Pasture Consortium

Present Consortium by-laws and business plan.

Other business to come to the Floor, such as resolutions and changes to Consortium research and extension priorities.

Jim Cropper, Executive Director, Thank you to the outgoing Executive Committee members, Welcome to the new Executive Committee members, and Announcement of the 2018 Public and Private Sector Co-Chairs

5:00 PM **Adjourn**

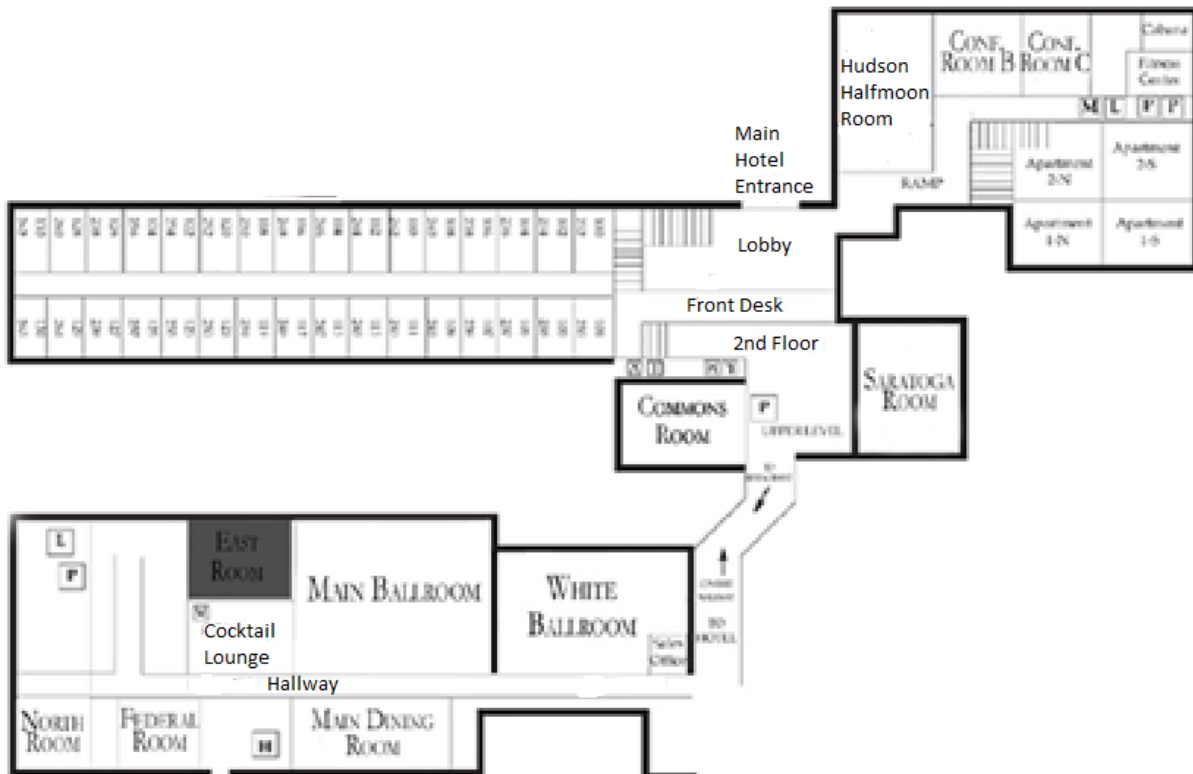

**2018 Northeast Pasture Consortium Annual Meeting Agenda
January 25-26, Century House Hotel & Conference Center, Latham, NY**

Poster Paper Titles and Authors

Grazing Guide: What can the Northeast Pasture Consortium website offer?

Goslee, Sarah

Ecologist, USDA-ARS Pasture Systems & Watershed Management Research Unit,
University Park, PA

Pasture Plants of the Northeastern US

Gonet, Jeff¹ and Sarah Goslee²

¹Agricultural Science Research Technician and

²Ecologist, USDA-ARS Pasture Systems & Watershed Management Research Unit,
University Park, PA.

Upper Susquehanna Coalition Comprehensive Riparian Buffer Program

Brinkley, Lydia¹ and Troy Bishopp²

¹Buffer Coordinator for the Upper Susquehanna Coalition/Tioga Co. SWCD, 183
Corporate Drive, Owego, NY.

²Upper Susquehanna Coalition East Regional Grazing Specialist/Madison County Soil
and Water Conservation District, Hamilton, NY.